

### A. ADJUST WIRES TO THE DESIRED LENGHT / HEIGHT

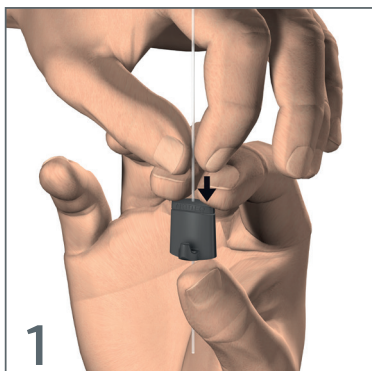

**1**  
Slide the Micro Grip hook on the Twister wire.

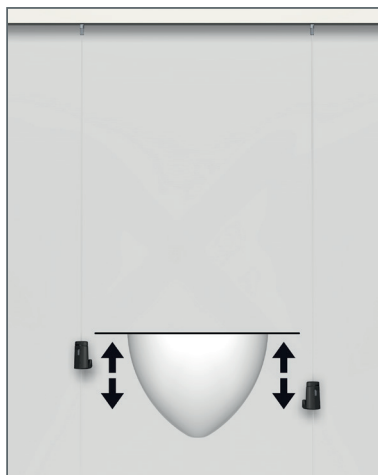
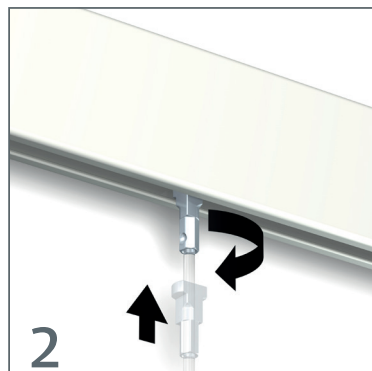

**2**  
Twist&turn both Twister wires with hook in the rail.

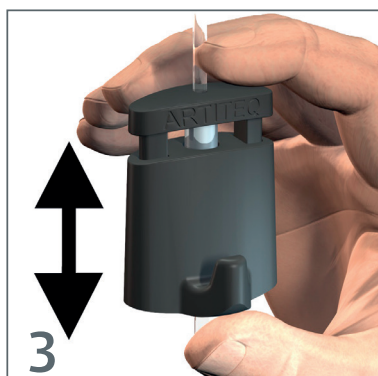

**3**  
Adjust both Micro Grip hooks at the same height.



**4**  
Make sure both hooks are at the desired height.

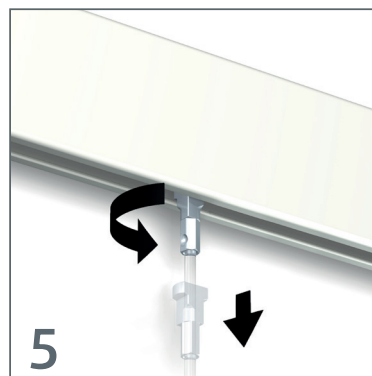

**5**  
Twist&turn both Twister wires out of the rail.

### B. HANG BOTANIQ FLOWERPOT



**1**  
Pull the wires from underneath through the opening.



**2**  
Position the hook in one of the 7 holes to lock.

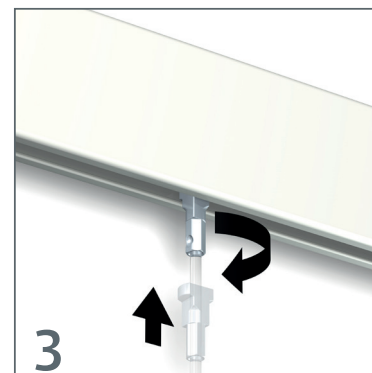

**3**  
Twist&turn both Twister wires in of the rail.



Installation video



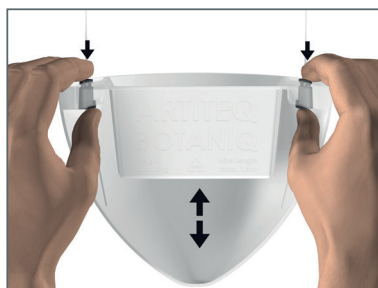

**4**

If desired, adjust the height with the Micro Grip hook.



**5**

Place plant in Botaniq with flowerpot or soil.

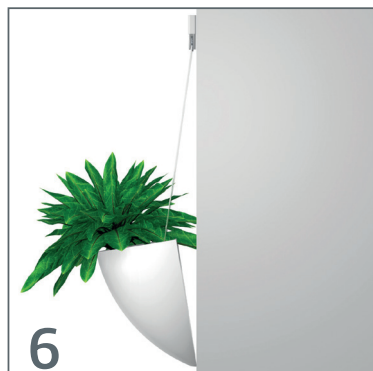

**6**

Check for tilting of the Botaniq.



**7**

Tilts forward? Slide hook to pos. 1. Backward? To pos. 7.



**8**

Botaniq is hanging stable against the wall.



**9**

Roll the remaining wire and stow behind the Botaniq.

**Note:** Botaniq can hold 2x 8cm or 1x 10cm flowerpot. Or place the plant directly with soil.

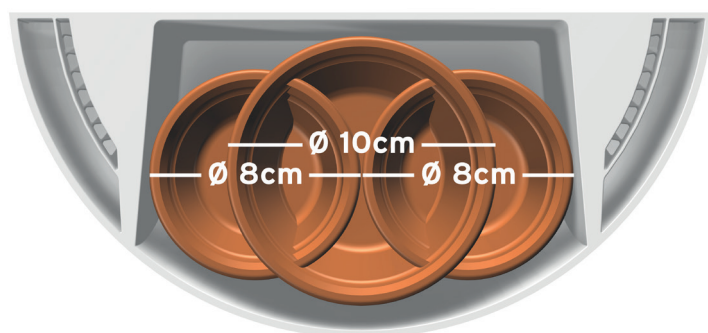

Installation video

