



# ArtiTeq®

flexible hanging systems

**FOR MUSEUMS, GALLERIES AND EXHIBITIONS**

# Artiteq®

Art moves, the wall remains intact!

**Opt for quality, sustainability and flexibility**

What originally started as a practical solution for displaying works of art in museums in a flexible manner has, over the past few decades, evolved into a versatile hanging system. Today, these systems are indispensable in museums, galleries and exhibition spaces. As part of this evolution, Artiteq, with over 30 years of experience, has become the leading specialist in hanging systems. Thanks to in-depth knowledge, Artiteq is a reliable partner for museums as well as offices, schools and institutions.

High standards are imposed in museums, galleries and exhibition spaces on the way in which works of art are displayed. Hanging works of art requires a solution that is not only flexible and secure, but also protects both the wall and the art itself. With our hanging systems, we offer a sustainable solution that meets all of those exacting standards.

**Artiteq brings security, reliability and functionality to every wall – from museums and galleries to exhibition spaces.**

## CONTENTS

INTRO	4	CLASSIC RAIL+ 40 kg p/m	14
HEAVY DUTY TRACK 200 kg p/m	6	CLICK RAIL 30 kg p/m	16
R70 RAIL 100 kg p/m	8	FRAME HANGERS fixed wall mounting	18
DOUBLE WALL TRACK 80 kg p/m	10	STORAGE SYSTEMS	20
CLICK RAIL PRO 50 kg p/m	12	SIGN HANGING SYSTEMS	22
		PRODUCT SPECIFICATIONS	24



**ART IN THE SPOTLIGHT!  
WE PROVIDE THE INVISIBLE SUPPORT**



## SECURITY, FLEXIBILITY AND STYLE

Artiteq's hanging systems offer the flexibility to be mounted on either the wall or ceiling using picture hanging systems. In this case, a rail is mounted directly to the wall and the works of art are hung securely using hanging wires and hooks. This is a choice where flexibility and the unnecessary drilling of holes are often the key considerations. In addition to this flexible hanging solution, Artiteq also offers fixed wall mounting for works of art. In this case, the works of art are mounted directly to the wall.

Whether you wish to display a temporary exhibition or a permanent museum collection, Artiteq offers the ideal solution for hanging light to very heavy works of art professionally, securely and reliably.

**BECAUSE EVERY  
MASTERPIECE DESERVES  
A RELIABLE PRESENTATION**



### Protection of walls and works of art

The system prevents damage to walls and provides optimal protection for both the exhibition spaces and the works of art. No unwanted holes in the wall, even when exhibitions change frequently.



### Fixed mounting and stability

The fixed mounting to the wall provides additional stability and security. The works of art remain securely in place, minimising the risk of falling or damage.



### Anti-theft system

For museums where security is of the highest importance, the system offers anti-theft solutions to provide extra protection for your valuable collection.



### Supports air circulation

Thanks to its ingenious design, the system allows air to circulate behind the work of art, helping to preserve the condition of vulnerable pictures and objects.

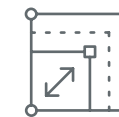

### Suitable for various sizes and weights

The system is easy to adjust, and is capable of supporting heavy works of art up to 80 kg, whilst remaining versatile enough to securely hold smaller objects.



### Minimalist and aesthetically pleasing design

The discrete design integrates seamlessly into any space, allowing the works of art to remain the focal point without distracting fixtures.



### Simple reorganisation

The flexible mounting allows works of art to be easily moved around or swapped without having to alter the wall again. Ideal for temporary exhibitions.



- high carrying capacity
- simple installation
- sustainable & damage-free

## HEAVY DUTY TRACK

for heavy works of art

**200**  
kg p/m

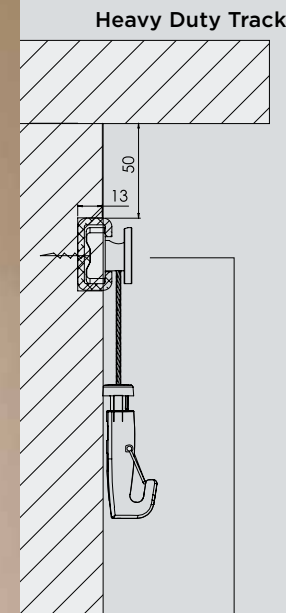

### A robust rail with 200-kg carrying capacity

The Heavy Duty Track is used for these heavier works of art. This special rail is made from steel and is attached directly to the wall or ceiling. From the side of this rail, the slides, equipped with steel wire, are slid to the desired position on the rail. These are secured using a screwdriver. Lighter pieces of art can also be attached to this rail.

### MAIN ADVANTAGES:

- **High carrying capacity:** suitable for hanging heavy works of art, up to 200 kg per metre.
- **Sustainable and damage-free:** no drilling holes or damage to walls.
- **Simple installation:** once-only and simple mounting to the wall.

In combination with the Heavy Duty Track, 1.8 and 2.5-mm steel wire can be used in combination with :

- **Track & Wire 1.2 - 1.8 mm / 15-40 kg:** attached directly on the back of the frame or

the picture. The steel wire is attached directly to the Track & Wire and this is locked with an automatic grip.

- **Auto Grip Lock 2.5 mm 70 kg:** is used when a different hanging point is used on the back of the frame or the picture, to which this can be attached.

**Auto Grip Lock  
2.5 mm 70 kg**

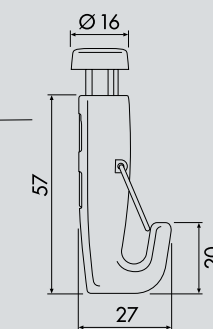

**Track & Wire  
1.2 - 1.8 mm / 15-40 kg**

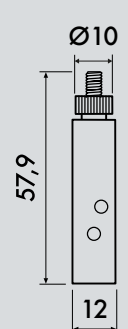

In museums, galleries and exhibition spaces, pieces of art, pictures and frames can be found in a variety of sizes; from light canvases to heavier works of art. For heavier works of art weighing up to 200 kg, a robust and reliable hanging system is essential.





- flexible reorganisation
- anti-theft
- museum quality

R70 Rail

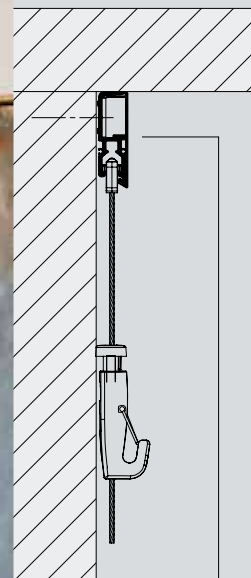

## R70 RAIL

a reliable solution

**100**  
kg p/m

The R70 Rail sets the standard for museums, galleries and exhibition spaces seeking a secure and professional solution for hanging their art collections. With its sleek design, high carrying capacity and ingenious functionality, this rail offers maximum flexibility without compromising on aesthetics.

The innovative design of this rail allows both the 2.5-mm steel hanging wires, equipped with an additional anti-theft clip, as well as the 1.8-mm steel hanging wires, to be used. The hanging system effectively combines the ability to securely hang both light and heavier works of art safely!

### MAIN ADVANTAGES:

- **High carrying capacity:** suitable for hanging heavy works of art, up to 100 kg per metre.
- **Discrete and minimalist design:** the rail is barely visible, ensuring the focus remains entirely on the works of art.
- **Anti-theft hanging:** ensures additional security with accessories specifically designed to delay unauthorised removal.
- **Simple to mount:** quick and easy to install, with smart mounting options designed for permanent and long-term use.
- **Flexible reorganisation:** easily swap and move works of art, without having to re-drill holes in the wall. Ideal for temporary exhibitions and seasonal shows.

### Specially designed for museums

The R70 Rail offers a system specifically designed to meet the highest standards laid down by museums. The combination of strength, security and aesthetics makes it an ideal choice for any professional exhibition space.





## COMPACT HANGING SYSTEM WITH HIGH CARRYING CAPACITY

### Reliable choice for every art connoisseur and professional

The Double Wall Track uses a special slider that easily hooks into the rail, at any desired position on the rail. The steel wire is attached to this slider and this is available in two thicknesses: 1.2 and 1.8 mm. Depending on the hanging requirements, two different hook types can be chosen from:

- **Auto Grip Lock 1.2 - 1.8 mm / 15-40 kg:** ideal if there is already a hanging point on the back of the frame or work of art.
- **Track & Wire 1.2 - 1.8 mm / 15-40 kg:** perfect when there is no hanging point. This is attached directly on the back of the frame or work of art.

In both cases, the steel wire is threaded through the hook, securely suspending the work of art from the slider, which remains hidden within the Double Wall Track. This not only ensures a sleek display, but also provides maximum security and flexibility.

**Auto Grip Lock**  
1.2 - 1.8 mm / 15-40 kg

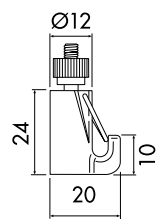

**Track & Wire**  
1.2 - 1.8 mm / 15-40 kg

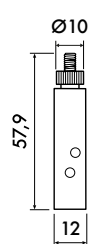

Double Wall Track

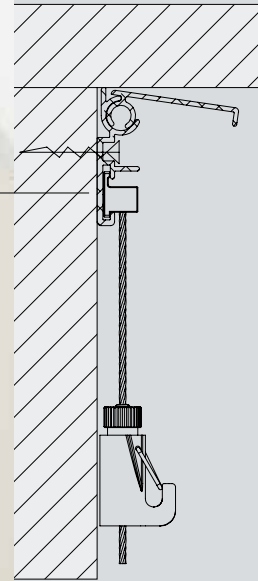

## DOUBLE WALL TRACK

compact and sturdy hanging system

**80**  
kg p/m

### For the secure hanging of heavy works of art

The Double Wall Track offers a smart and discrete way of hanging works of art, ideal for museums and exhibition spaces. The system comprises two parts: a sturdy base rail that is attached to the wall and a top rail that is placed over it. This not only ensures a neat finish, but also provides a secure hanging solution without damaging the wall.

### MAIN ADVANTAGES:

- **Neat finish:** the cover fits seamlessly over the rail.
- **Flexible use:** slider with steel wire which can be attached at any desired position on the rail.
- **High carrying capacity:** suitable for works of art up to 80 kg per metre.
- **Sustainable and damage-free:** no drilling holes or wall damage.
- **Can be painted over:** the cover can be repainted in any colour desired.
- **Discrete design:** seamlessly integrated into any space, ensuring the focus remains on the work of art.

The Double Wall Track does not compromise the style and functionality. This system doesn't only ensure a professional look, but also ensures that the works of art are hung safely and securely.

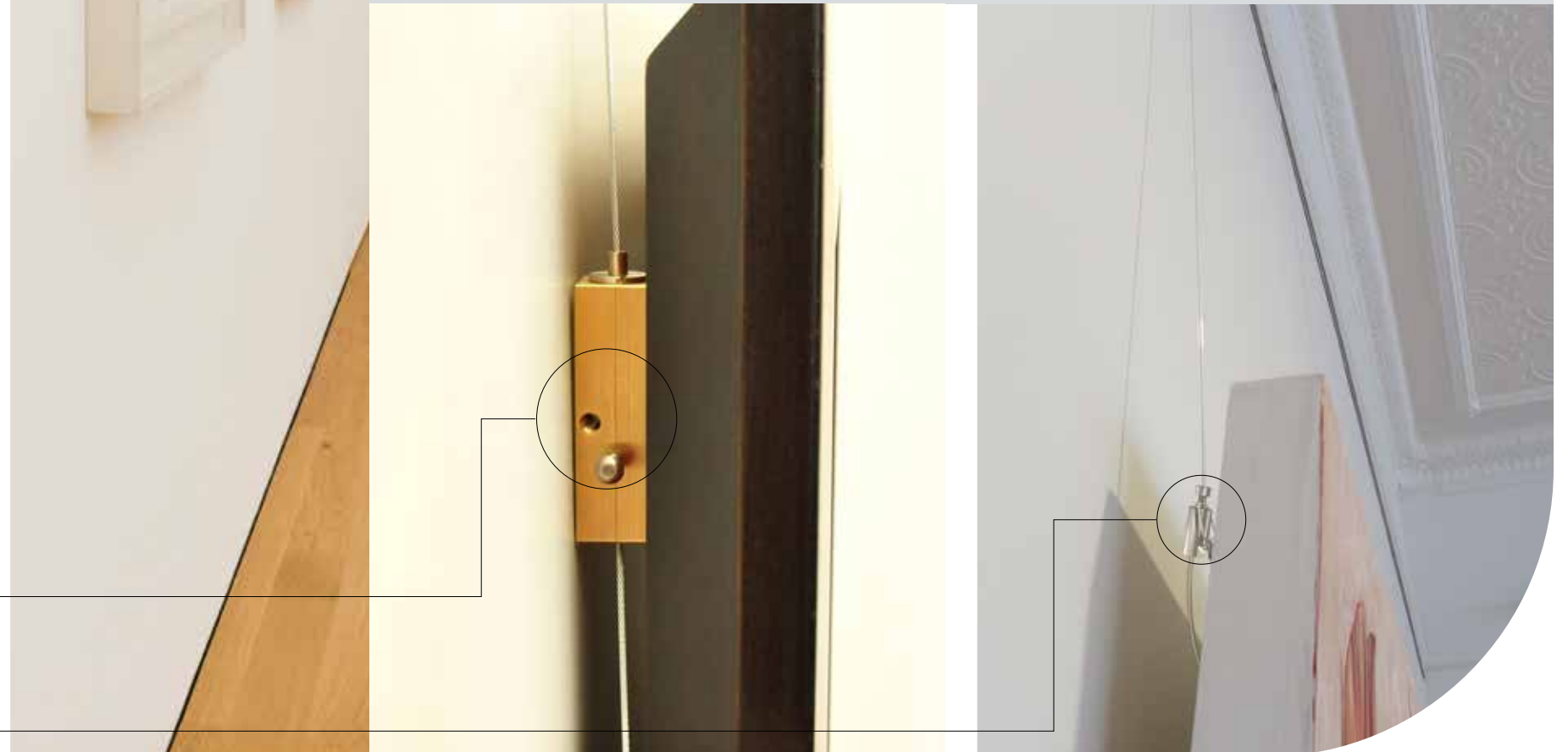

- simple changeover
- aesthetically pleasing
- modern and industrial

Click Rail Pro

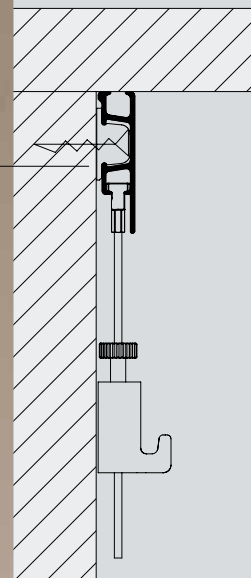

## CLICK RAIL PRO

solid hanging system

**50**  
kg p/m

For galleries and exhibition spaces where hanging and changing works of art is a regular activity, the Click Rail Pro provides an ideal solution. This reliable picture hanging system has been specially developed for larger pictures and frames. With its clever design and high carrying capacity, the Click Rail Pro is a secure and flexible choice for any professional environment.

The Click Rail Pro combines the strength of a robust system with the flexibility to easily reorganise exhibitions. Whether it is used for large-scale pictures, heavy frames or unique objects, this system delivers the security that smaller museums, galleries and exhibition spaces need.

### MAIN ADVANTAGES:

- **High carrying capacity:** suitable for the secure hanging of heavier works of art, up to 50 kg per metre.
- **Quick and easy to mount:** the Click & Connect clips allow the rail to be mounted flush against the ceiling, ensuring a seamless and neat finish.
- **Flexible layout:** works of art can be easily moved around or swapped without damaging the wall, ideal for temporary exhibitions.
- **TÜV certified:** tested and approved in accordance with strict safety standards for maximum reliability.
- **Aesthetically pleasing and functional:** the rail is unobtrusive, allowing the works of art to remain the focal point without distracting elements.

### Reliability, style and flexibility in every exhibition

In galleries and exhibition spaces, it is essential to change works of art frequently. The Twister hanging wires allow exhibitions to easily be changed, without damaging the walls or time-consuming mounting. Works of art can be quickly moved around, hung or swapped, ensuring the exhibition is always in motion.

- **Robust and industrial:** opt for the 1.8-mm steel hanging wires for a sturdy and powerful look, ideal for modern or industrial settings.
- **Minimalist and unobtrusive:** choose the 1.8-mm Twister Perlon hanging wires if a subtle, almost invisible display is preferred.

The Twister hanging wires offer flexibility to display art at the perfect height and position, without any limitations.



## CLASSIC RAIL+

strong and versatile hanging system

**40**  
kg p/m

The Classic Rail+ is a robust picture hanging system, specially designed for securely and flexibly hanging heavy works of art and wall decorations, weighing up to 40 kg per metre.

With its open J-shaped design (9x20 mm), hanging rods and hooks can easily be placed and moved around, allowing works of art to be swapped effortlessly without damaging the walls. This means the rail is ideal for dynamic exhibitions and collections that are frequently updated.

For enhanced security and theft prevention, optional anti-theft hooks and locking mechanisms can be incorporated. The Classic Rail+ is available in white, black and aluminium, ensuring this blends in perfectly with different interior styles.

### MAIN ADVANTAGES:

- **High carrying capacity:** suitable for works of art up to 40 kg per metre.
- **Flexible use:** works of art can easily be swapped and moved around.
- **Extra security:** optional anti-theft hooks for additional security.
- **Streamlined and discrete:** available in several colours for a professional look.
- **Simple mounting:** can be installed quickly and efficiently.
- **TÜV certified:** tested and approved in accordance with strict safety standards for maximum reliability.

With the Classic Rail+, Artiteq offers a strong, secure and flexible hanging solution for every exhibition environment.

Classic Rail+

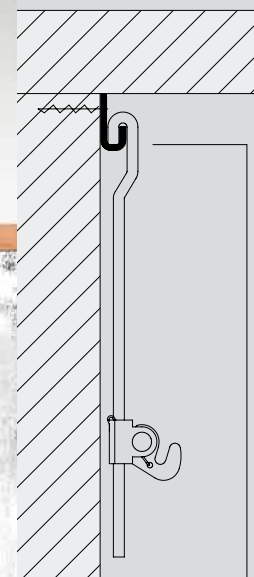

- streamlined & unobtrusive
- sustainable and robust
- maximum flexibility





**CLICK RAIL**

professional art displays

**30**  
kg p/m**Versatile and subtle hanging system**

For museums and exhibition spaces where flexibility and aesthetics go hand-in-hand, the Click Rail offers a versatile and sustainable solution. This system is ideal for the simple hanging, moving and swapping of works of art, without damaging the walls.

The Click Rail is mounted once only to the wall using the smart Click & Connect system, which ensures fast installation and a streamlined finish. The rail can be mounted flush against the ceiling and can be painted to match the colour of the wall or the ceiling, making this almost invisible in the exhibition space.

With a carrying capacity of up to 30 kg per metre, this hanging system is ideal for medium-sized works of art and frames. The Twister hanging wires allow works of art to be hung at any preferred height

and position, with no drilling of holes being required.

**MAIN ADVANTAGES:**

- **Sustainable and flexible:** effortlessly change works of art without damaging the walls.
- **Aesthetically pleasing and minimalist:** a streamlined and unobtrusive finish, blends seamlessly into the interior.
- **Reliable carrying capacity:** suitable for works of art up to 30 kg per metre.
- **Simple mounting:** can be installed quickly with Click & Connect clips.
- **TÜV certified:** tested and approved in accordance with strict safety standards for maximum reliability.

With the Click Rail, Artiteq offers an elegant, versatile and practical hanging system that effortlessly harmonises with the dynamics of museums and galleries.

Click Rail

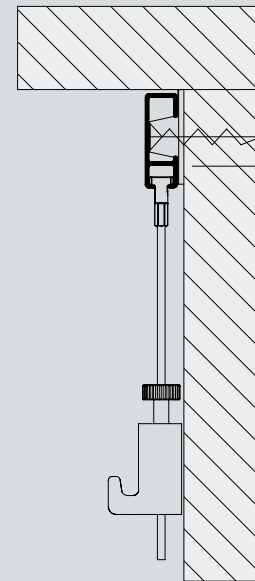

- high carrying capacity
- simple installation
- sustainable & damage-free

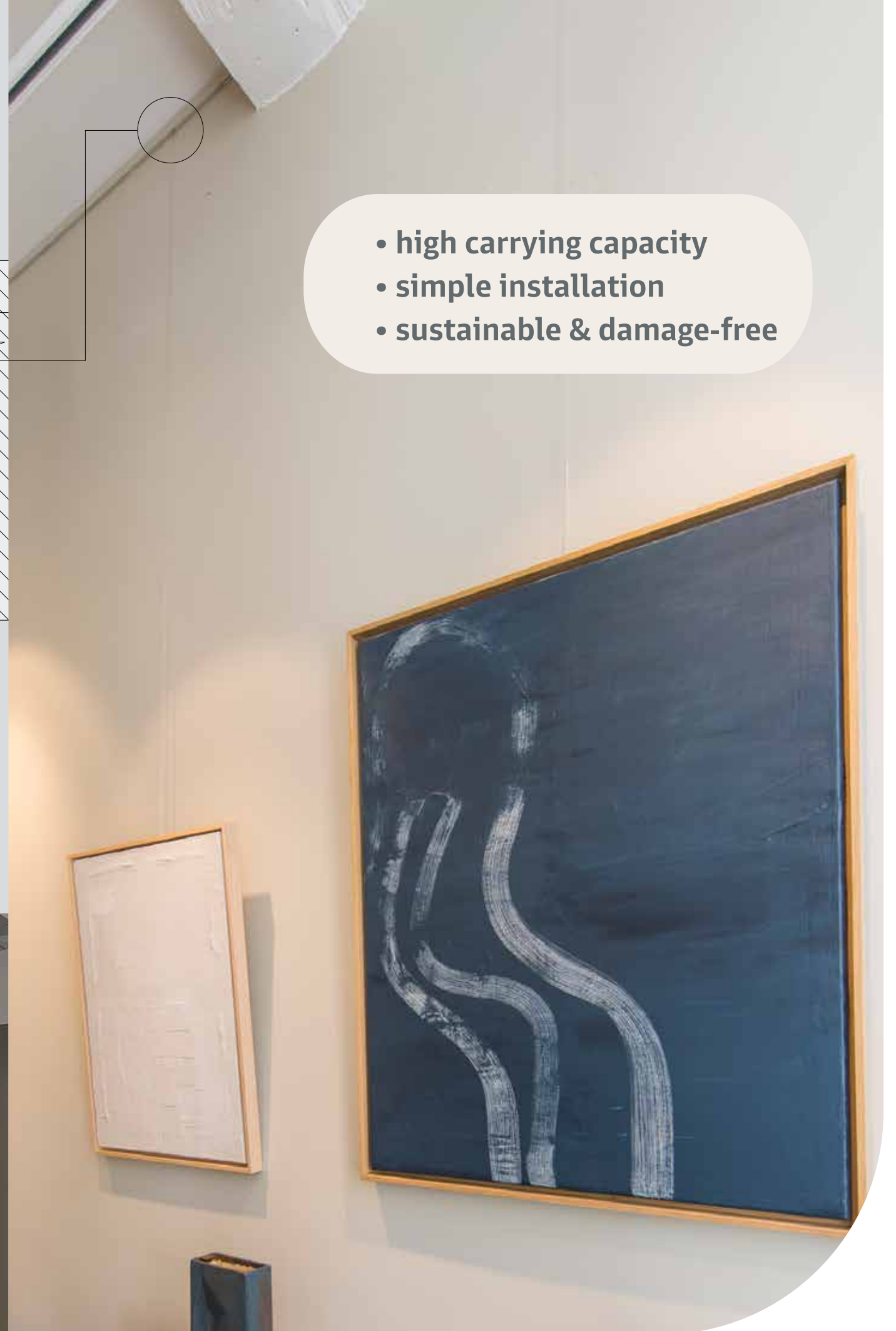

## FRAME HANGERS

secure and fixed mounting to the wall

For secure hanging and attachment of art, pictures and (heavy) frames to the wall, we offer Frame Hangers. The Frame Hangers, such as the Track Junior, are attached directly and permanently to the back of the frame. The size and weight of the piece of art dictates which type of Frame Hanger is required. These have a mechanical anti-theft function and can be adjusted both vertically and horizontally.

When using the Frame Hangers, the works of art are not attached directly against the wall; a minimal gap of 6 to 13 mm is left between the wall and the work of art. This ensures that air can circulate properly behind the work of art. The correct humidity and air circulation are crucial for ensuring that pictures and works of art can be enjoyed for years to come. Monitoring the temperature and regulating humidity in museums is crucial to prevent the ageing of pictures and frames.

### MAIN ADVANTAGES:

- **Adjustable:** the piece of art is horizontally and vertically adjustable on the wall.
- **Anti-theft:** fitted with mechanical theft protection.
- **Air circulation:** the works of art do not hang directly against the wall (gap of 6-13 mm).

If fixed mounting is required, these Frame Hangers are an excellent product for secure and reliable hanging. The Frame Hangers can be combined with Depot Screws, for hanging inside storage facilities.

Track Junior 40 kg

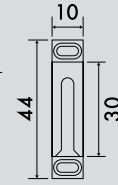

Track Junior M 80 kg

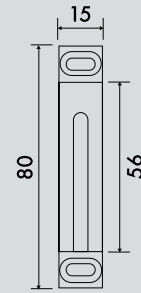

Track & Slide M 100 kg

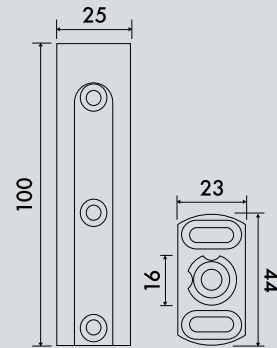

### For fixed mounting

In just a few steps, the Frame Hangers are securely attached to the back of a picture or work of art. In this way, the picture or work of art hangs directly against the wall.



- safe storage
- efficient use of space
- flexible and accessible



#### Storage in a depot

The Depot Screws are used in combination with the Frame Hangers to store pictures safely in storage facilities.

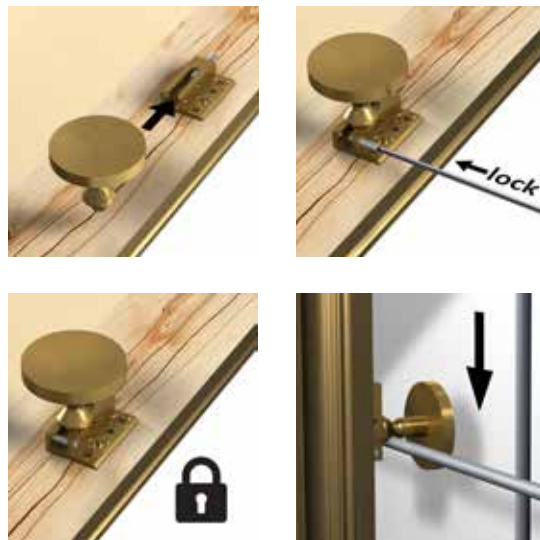

## STORAGE SYSTEMS

safe hanging in storage facilities

Depot Screw Junior  
Junior BU

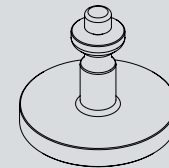

Depot Screw Junior  
Junior M

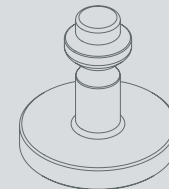

Unfortunately, not all works of art, pictures and frames owned by a museum are on display. Generally, up to 90% of an art collection is stored in the depot. Many museums have their own depot/storage facilities where the many works of art and pictures are safely stored. They are stored until a (temporary) exhibition is held requiring these pieces, or when a work of art is lent out. This is an important space that needs to be efficiently organised. Pictures can be stored in various ways, where hanging is common practice.

For the hanging storage of artworks in a depot, Artiteq offers storage systems combined with the Frame Hangers. With the simple Depot Screw, works of art are securely hung on a grid/mesh rack.

#### MAIN ADVANTAGES:

- Easily screwed into the Frame Hanger.
- Can easily be hung on depot grid walls
- Can carry heavy weights.
- The back of the picture does not have to be damaged again.

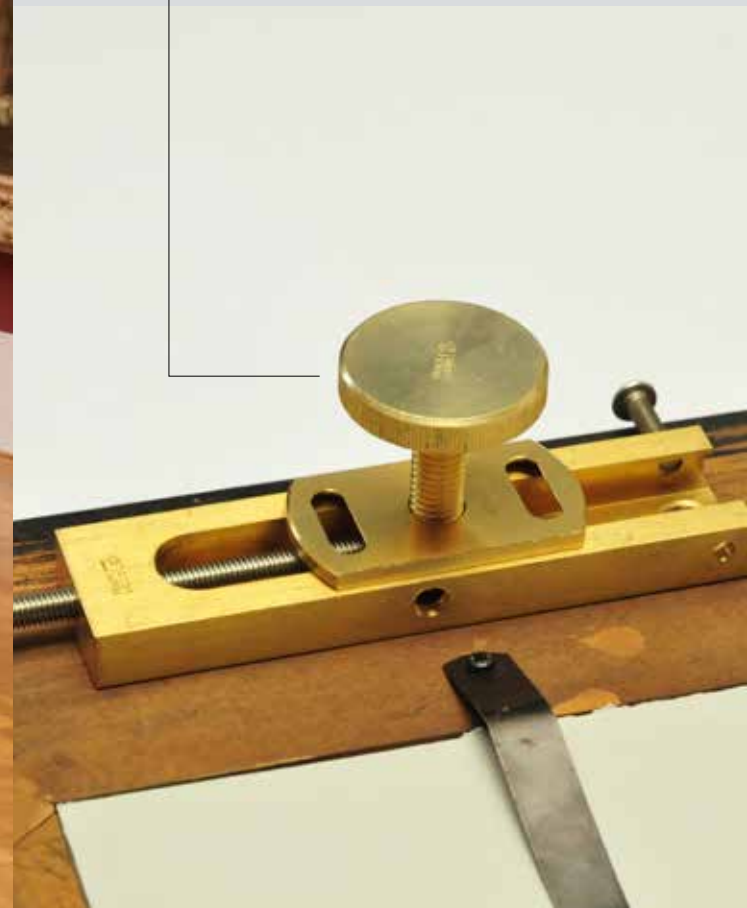



PARKING  
TOILETS  
WAITING ROOM  
1ST FLOOR

## SIGN HANGING SYSTEMS

clear route, smartly organised

Clear signage showing routes to follow is essential for visitors to a museum, gallery or exhibition space. It ensures safety and helps visitors to easily find their way around when looking for a certain artist or exhibition theme.

The Artiteq Sign Hanging Systems, such as the Suspended Ceiling Clip Hanger, seamlessly integrate into suspended ceilings without the need for drilling. This allows walls to remain free of fixings or damage, whilst ensuring that the signage remains secure and highly visible.

In addition to the suspended ceiling systems, Artiteq also offers solutions for hanging signage from concrete ceilings. Thanks to the wide range of hooks, but also the easy mounting, the signage boards can be effortlessly hung and easily swapped whenever needed.

The minimalist design of the Sign Hanging Systems provides a professional look without unnecessary distractions. It is a sustainable and flexible solution for clear wayfinding in museums, galleries and exhibition spaces.



PARKING ←  
EXIT ↓



HEAVY DUTY TRACK

for heavy works of art

200  
kg p/m



White  
RAL9010

10  
YEAR  
WARRANTY

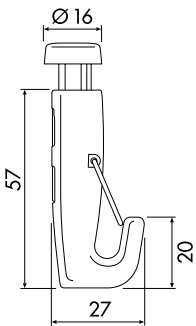
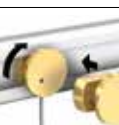
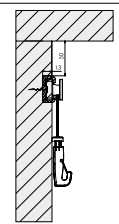

Auto Grip Lock 2.5 mm 70 kg



Track & Wire 1.2 - 1.8 mm / 15-40 kg

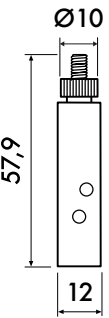

DOUBLE WALL TRACK

compact and sturdy hanging system

80  
kg p/m

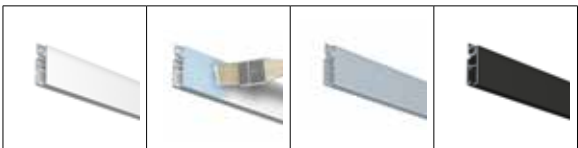

White  
RAL9010

White Primer  
RAL9016

Aluminium

Black

Wire	Hook	Carrying capacity
1.2-mm steel wire	Auto Grip Lock   Track & Wire	15 kg
1.8-mm steel wire	Auto Grip Lock   Track & Wire	40 kg

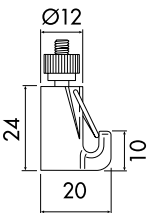

Auto Grip Lock 1.2 - 1.8 mm / 15-40 kg



Track & Wire 1.2 - 1.8 mm / 15-40 kg

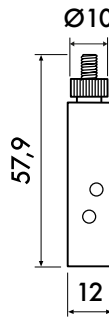

10  
YEAR  
WARRANTY

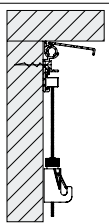

## R70 RAIL

a reliable solution

**100**  
kg p/m



White Primer  
RAL9016

**10**  
YEAR  
WARRANTY

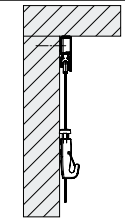

## CLASSIC RAIL+

strong and versatile hanging system

**40**  
kg p/m



White  
RAL9010

Aluminium

Black

**10**  
YEAR  
WARRANTY

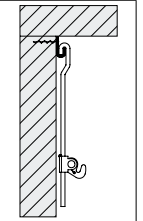

## CLICK RAIL PRO

solid hanging system

**50**  
kg p/m



Brushed  
aluminium

White Primer  
RAL9016

**10**  
YEAR  
WARRANTY

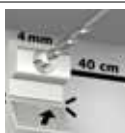
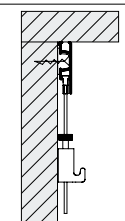

## CLICK RAIL

professional art displays

**30**  
kg p/m



White  
RAL9010

White Primer  
RAL9016

Brushed  
aluminium

Black

**10**  
YEAR  
WARRANTY

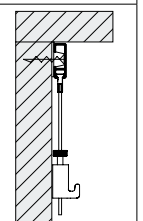



FRAME HANGERS

secure and fixed mounting to the wall

Track Junior

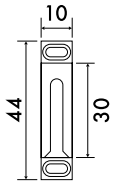

40  
KG

10  
YEAR  
WARRANTY

Track Junior M

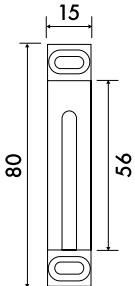

80  
KG

10  
YEAR  
WARRANTY

Track & Slide M

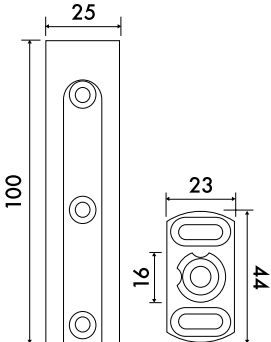

100  
KG

10  
YEAR  
WARRANTY

STORAGE IN A DEPOT

safe hanging in storage facilities

Depot Screw Junior M



10  
YEAR  
WARRANTY

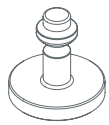

Depot Screw Junior Junior BU



10  
YEAR  
WARRANTY

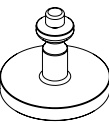

SIGN HANGING SYSTEMS

clear route, smartly organised



White

Black



White

Black





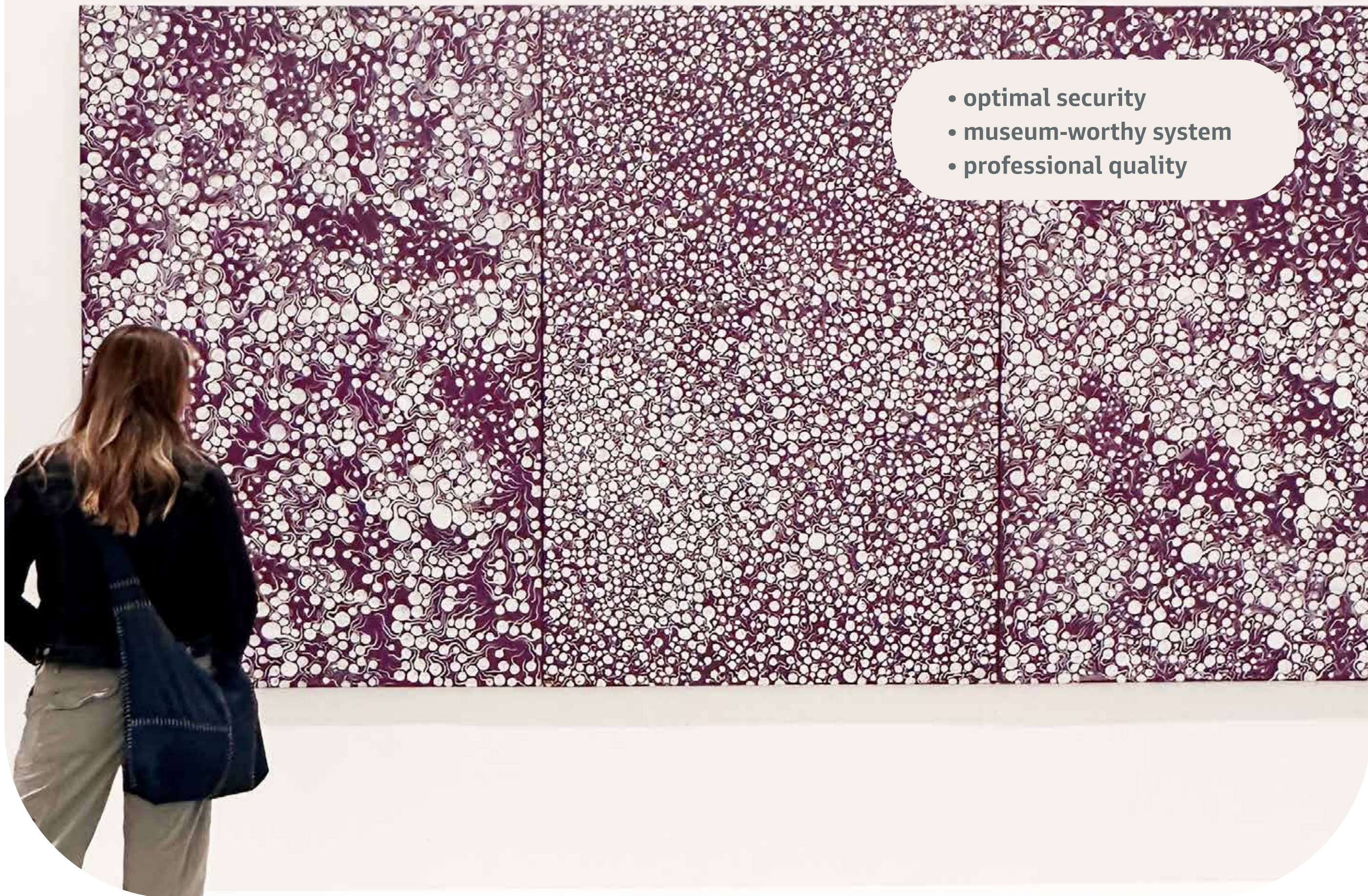

- optimal security
- museum-worthy system
- professional quality





ARTITEQ

Herastraat 39  
5047 TX Tilburg  
The Netherlands

+31 (0)13 572 90 70  
[info@artiteq.com](mailto:info@artiteq.com)  
[artiteq.com](http://artiteq.com)